

REV	DESCRIPTION	ECN/ECR	DATE	DRAWN BY
△0	新訂圖面	—	03/09/2013	黃志強
△1	修改端子座結構	ECR	09/30/2013	黃志強

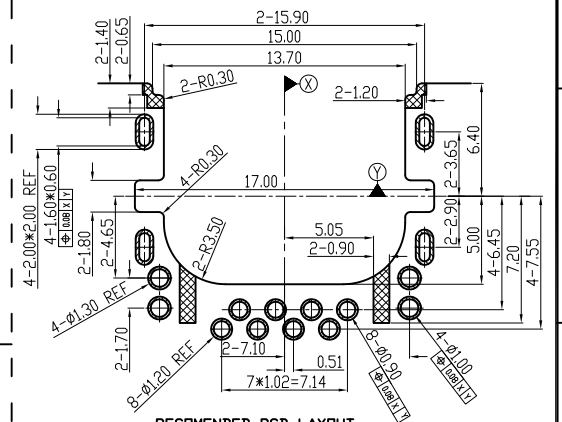

RECOMMENDED PCB LAYOUT
TOLERANCE:±0.05mm
RECOMMENDED PCB THICKNESS:1.20±0.05

- NOTES:
- MATERIAL:
 - HOUSING:PA9T(GP2450);UL 94V-0, COLOR:BLACK
 - TERMINAL BASE:LCP;UL 94V-0, COLOR:BLACK
 - TERMINAL:PHOSPHOR BRONZE(C5210R);T=0.25±0.05mm TREATMENT:1U"G/50U"MATTE TIN
 - SHELL:SUS(201);T=0.20±0.05mm,TREATMENT:50U" NI
 - LED:GREEN/YELLOW,TREATMENT:TIN
 - ELECTRICAL CHARACTERISTICS:
 - CURRENT RATING: 1.5 AMPERES MAX.
 - VOLTAGE RATING: 150 VAX MAX.
 - INSULATION RESISTANCE:500M OHMS MIN.AT 500V DC.
 - DIELECTRIC WITHSTANDING VOLTAGE: 800V AC60HZ 1MINUTE.
 - LED'S CHARACTERISTICS:
 - FORWARD CURRENT:25±5mA.
 - FORWARD VOLTAGE:2.2 VOLTS TYPICAL.
 - REVERSE VOLTAGE:5.0 VOLTS MAX.
 - LED Luminous intensity5~10mcd
 - YELLOW LED Wavelength 585~597nm
 - GREEN LED Wavelength 564.5~576.5nm
 - LOW LEVEL CONTACT RESISTANCE:50 MILLIOHMS INITIAL.
 - MECHANICAL CHARACTERISTICS:
 - MATING FORCS:5 POUNDS MAX WITH LATCH DEPRESSED.
 - DURABILITY(MATING/UNMATING CYCLES):5000 CYCLES.
 - OPERATING TEMPERATURE: -30°C TO +70°C
 - KEEP OUT FEATURE OF MOOEM PIUG :.25kgf MIN

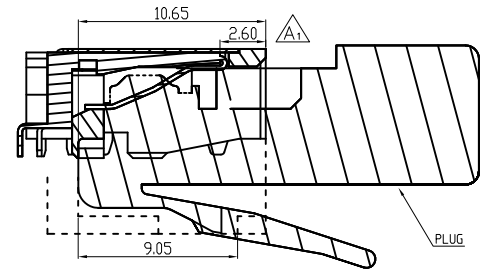
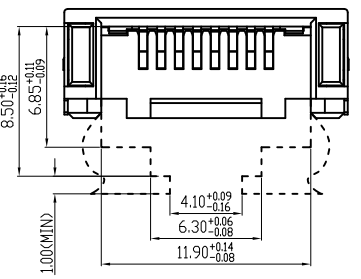
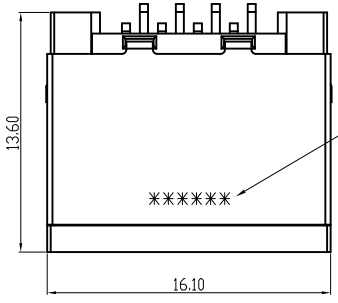
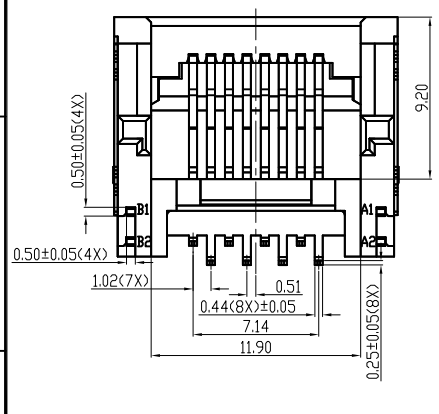
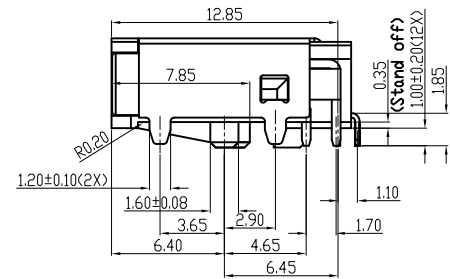
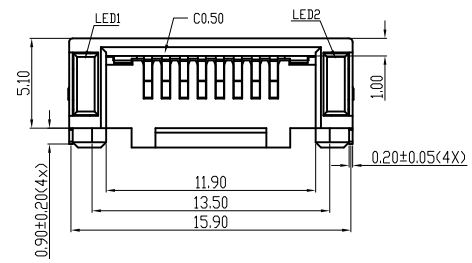
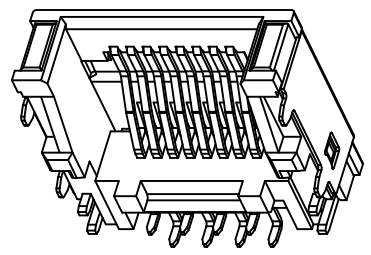

TABLE:

Part Number(客戶)		AU
RJ45-2RJ1656-000111F		G/F
G/F	CD4531012006	-01 WHITE NI YES
AU PLATING	PART NUMBER-XX	SHELL PLATING HF

LED CHARACTERISTIC			
LED 1	B1(-)	B2(+)	YELLOW
LED 2	A1(-)	A2(+)	GREEN



東莞世華電子有限公司
SHYH HWA ELECTRONICS CO.,LTD.(DONGGUAN)
地址:東莞市塘廈鎮諸佛嶺178工業區
TEL:0769-87910020-1 FAX:0769-87910210

DRAWN BY	黃志強	ITEM	半截式RJ45 PHONE JACK(H=5.10mm)
CHECKED BY			
APPROVED BY		PART NO	CD4531012006-XX

ANGLE PROJECTION		UNIT	mm
		SCALE	1:1
TOLERANCE	.X±0.30 .XX±0.20	DATE	09/30/2013