

REV	DESCRIPTION	ECN/ECR	DATE	DRAWN BY
A0	新訂圖面	—	04/07/2017	胡久量
A1	修改LED顏色	ECR	06/12/2017	胡久量
B1	修改PLUG位置及後塞及膠殼結構	ECR	01/08/2018	鍾航

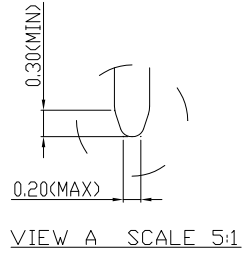
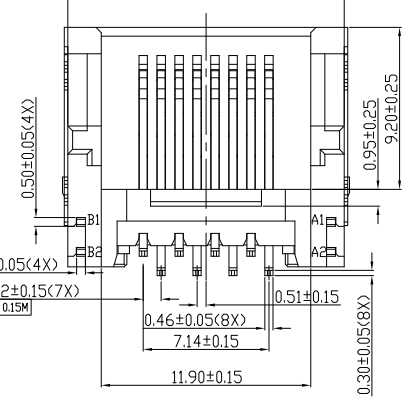
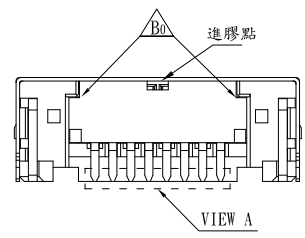
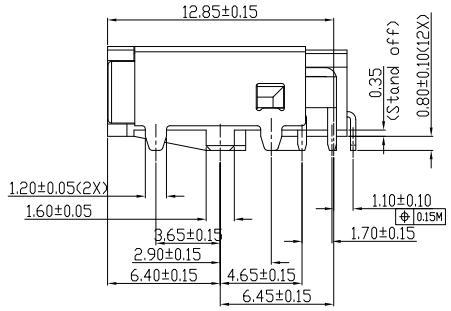
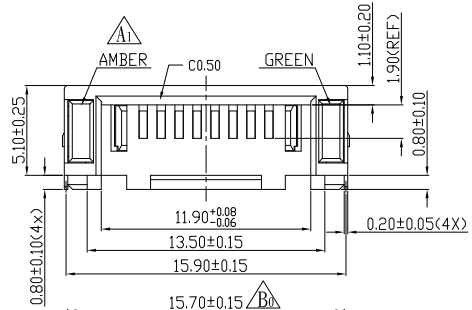
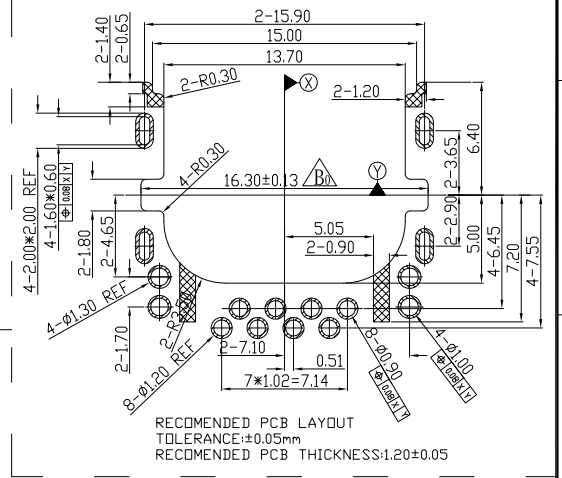
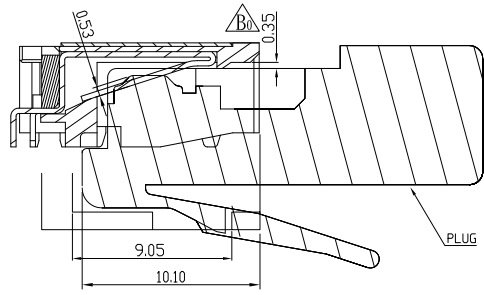
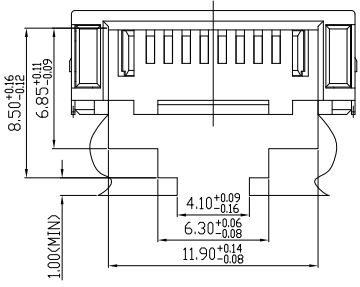
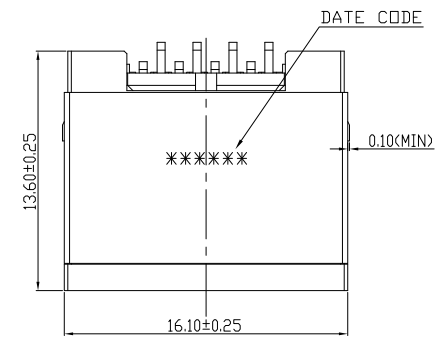

Part Number(客戶)	AU
2RJ1656-10111F	G/F

LED CHARACTERISTIC		
B1(-)	B2(+)	AMBER
A1(-)	A2(+)	GREEN

- NOTES:
- MATERIAL:
 - HOUSING: PA10T+35%GF(VICNLY R635NH); UL 94V-0, COLOR: BLACK
 - TERMINAL: PHOSPHOR BRONZE(C5210R); T=0.30±0.05mm TREATMENT: 1u" G/50U" MATTE TIN DN SOLDER TAIL, ALL OVER NI 30u" MIN.
 - SHELL: SUS(201); T=0.20±0.05mm, TREATMENT: 50u" NI
 - LED: GREEN/AMBER, TREATMENT: TIN
 - CAP: LCP(E130D); COLOR: BLACK
 - ELECTRICAL CHARACTERISTICS:
 - CURRENT RATING: 1.5 AMPERES MAX.
 - VOLTAGE RATING: 150 VAX MAX.
 - INSULATION RESISTANCE: 500M OHMS MIN. AT 500V DC.
 - DIELECTRIC WITHSTANDING VOLTAGE: 800V AC 60HZ 1MINUTE.
 - LED'S CHARACTERISTICS:
 - FORWARD CURRENT: 25±5mA.
 - FORWARD VOLTAGE: 2.2 VOLTS TYPICAL.
 - REVERSE VOLTAGE: 5.0 VOLTS MAX.
 - LED Luminous intensity 5~10mcd
 - AMBER LED Wavelength 600~612nm
 - GREEN LED Wavelength 564.5~576nm
 - LOW LEVEL CONTACT RESISTANCE: 45 MILLIOHMS INITIAL.
 - MECHANICAL CHARACTERISTICS:
 - MATING FORCWS: 5 POUNDS MAX WITH LATCH DEPRESSED.
 - DURABILITY(MATING/UNMATING CYCLES): 5000 CYCLES.
 - OPERATING TEMPERATURE: -30°C TO +70°C
 - KEEP OUT FEATURE OF MOOEM PLUG : 2.5kgf MIN
 - IR reflow peak temp: 10S MIN

東莞世華電子有限公司
 SHYH HWA ELECTRONICS CO., LTD. (DONGGUAN)
 地址: 東莞市塘廈鎮諸佛嶺178工業區
 TEL: 0769-87910020-1 FAX: 0769-87910210

DRAWN BY	鍾航	ITEM	半截式RJ45 PHONE JACK(H=5.10mm 插PIN式) (英業達專用)
CHECKED BY			
APPROVED BY		PART NO	CD4531062004

ANGLE PROJECTION	UNIT	mm
	SCALE	1:1
TOLERANCE	DATE	01/08/2018
.X±0.20 .XX±0.10		